

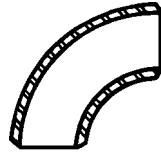

90° Long Radius Elbows
Standard Weight



Part #	Size	Price
060-0008	1/2"	22.03
060-0016	3/4"	22.03
060-0024	1"	22.03
060-0032	1-1/4"	22.03
060-0040	1-1/2"	22.03
060-0058	2"	30.80
060-0074	2-1/2"	37.32
060-0082	3"	45.55
060-0090	3-1/2"	75.06
060-0104	4"	75.06
060-0112	5"	161.82
060-0120	6"	165.52
060-0138	8"	312.56
060-0146	10"	622.11
060-0154	12"	921.45

Extra Heavy

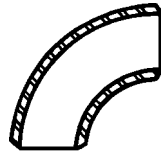

Part #	Size	Price
060-5008	3/4"	28.93
060-5016	1"	28.93
060-5024	1-1/4"	28.93
060-5040	2"	36.93
060-5042	3"	66.57

90° Reducing Elbows
Standard Weight

Part #	Size	Price
059-0193	3" x 2"	45.55

45° Elbows
Standard Weight

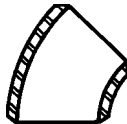

Part #	Size	Price
060-0696	3/4"	23.42
060-0700	1"	23.42
060-0718	1-1/4"	23.42
060-0726	1-1/2"	23.42
060-0734	2"	30.07
060-0742	2-1/2"	36.02
060-0750	3"	37.32
060-0776	4"	67.25
060-0784	5"	101.96

45° Elbows
Standard Weight (Continued)

Part #	Size	Price
060-0792	6"	132.33
060-0806	8"	220.39
060-0814	10"	439.90

Tees
Standard Weight

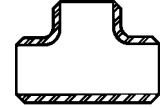

Part #	Size	Price
060-1084	1/2"	72.53
060-1092	3/4"	72.53
060-1106	1"	72.53
060-1114	1-1/4"	72.53
060-1122	1-1/2"	72.53
060-1130	2"	74.19
060-1148	2-1/2"	102.38
060-1156	3"	114.10
060-1172	4"	160.09
060-1180	5"	264.21
060-1198	6"	275.05
060-1202	8"	479.83
060-1210	10"	942.71
060-1228	12"	1319.28

Extra Heavy

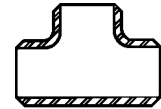

Part #	Size	Price
060-5146	1"	71.61
060-5162	1-1/4"	71.61
060-5188	2"	81.60

Reducing Tees
Standard Weight

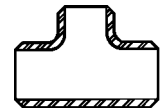

Part #	Size	Price
060-1404	2" x 2" x 1"	124.08
060-1412	2" x 2" x 1-1/4"	124.08
060-1420	2" x 2" x 1-1/2"	124.08
060-1496	2-1/2" x 2-1/2" x 1-1/4"	136.23
060-1500	2-1/2" x 2-1/2" x 1-1/2"	136.23
060-1518	2-1/2" x 2-1/2" x 2"	136.23
060-1580	3" x 3" x 1-1/4"	132.75
060-1584	3" x 3" x 1-1/2"	132.75
060-1592	3" x 3" x 2"	132.75
060-1606	3" x 3" x 2-1/2"	132.76
060-1672	4" x 4" x 2"	160.09
060-1680	4" x 4" x 2-1/2"	160.09

INDEPENDENT WHOLESALE DISTRIBUTOR



Reducing Tees
Standard Weight (Continued)

Part #	Size	Price
060-1698	4" x 4" x 3"	160.09
060-1874	6" x 6" x 3"	344.08
060-1890	6" x 6" x 4"	344.08
060-1996	8" x 8" x 6"	624.28

Concentric Reducers
Standard Weight

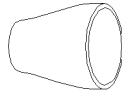

Part #	Size	Price
060-2174	1" x 3/4"	72.84
060-2204	1-1/4" x 1"	72.84
060-2244	1-1/2" x 3/4"	72.84
060-2246	1-1/2" x 1"	72.84
060-2254	1-1/2" x 1-1/4"	72.84
060-2318	2" x 1"	64.54
060-2326	2" x 1-1/4"	46.60
060-2334	2" x 1-1/2"	46.60
060-2392	2-1/2" x 1"	120.70
060-2406	2-1/2" x 1-1/4"	101.59
060-2414	2-1/2" x 1-1/2"	75.88
060-2422	2-1/2" x 2"	58.56
060-2472	3" x 1"	118.91
060-2480	3" x 1-1/4"	94.42
060-2498	3" x 1-1/2"	59.76
060-2502	3" x 2"	51.99
060-2510	3" x 2-1/2"	48.40
060-2600	3-1/2" x 2"	129.67
060-2658	4" x 2"	75.88
060-2666	4" x 2-1/2"	75.88
060-2674	4" x 3"	62.14
060-2682	4" x 3-1/2"	65.14
060-2754	5" x 3"	157.15
060-2762	5" x 4"	115.33
060-2826	6" x 2"	393.16
060-2842	6" x 3"	157.70
060-2868	6" x 4"	130.27
060-2948	8" x 3"	479.20
060-2956	8" x 4"	219.89
060-2972	8" x 6"	170.89
060-3118	10" x 6"	311.31
060-3126	10" x 8"	331.62

Eccentric Reducers
Standard Weight

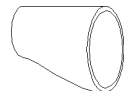

Part #	Size	Price
060-3320	1-1/2" x 1-1/4"	98.65
060-3386	2-1/2" x 2"	69.31

Eccentric Reducers
Standard Weight (Continued)

Part #	Size	Price
060-3440	3" x 2"	81.26
060-3458	3" x 2-1/2"	75.88
060-3596	4" x 2"	120.70
060-3600	4" x 2-1/2"	104.57
060-3618	4" x 3"	99.19
060-3714	5" x 4"	200.17
060-3764	6" x 3"	320.27
060-3780	6" x 4"	204.35

Extra Heavy

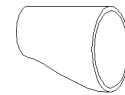

Part #	Size	Price
060-3341	2" x 3/4"	513.85

Caps
Standard Weight

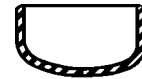

Part #	Size	Price
060-3966	3/4"	27.09
060-3974	1"	27.09
060-3982	1-1/4"	27.09
060-3990	1-1/2"	27.09
060-4006	2"	27.09
060-4014	2-1/2"	31.51
060-4022	3"	31.51
060-4048	4"	45.97
060-4064	5"	70.76
060-4072	6"	78.51
060-4080	8"	118.79
060-4098	10"	215.36
060-4102	12"	324.86

Extra Heavy



Part #	Size	Price
060-5322	2"	29.96



Forged Steel Flanges - 150#
Weld Neck
Raised Face Standard Bore 150#

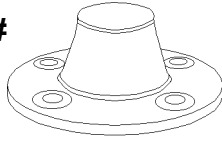

Part #	Size	Price
061-0002	1"	41.56
061-0028	1-1/2"	41.56
061-0036	2"	45.87
061-0044	2-1/2"	49.86
061-0052	3"	54.44
061-0078	4"	83.44
061-0086	5"	105.35
061-0094	6"	99.82
061-0108	8"	176.33
061-0116	10"	282.41
061-0118	12"	410.40

Flat Face Standard Bore 150#

Part #	Size	Price
061-0270	2"	45.87
061-0296	3"	54.44
061-0300	4"	66.08
061-0326	6"	127.54
061-0350	12"	454.42

Slip On
Raised Face Standard Bore 150#

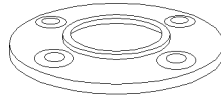

Part #	Size	Price
061-1926	14"	469.34

Flat Face Standard Bore 150#

Part #	Size	Price
061-1588	1-1/2"	29.74
061-1596	2"	30.44
061-1600	2-1/2"	52.10
061-1618	3"	41.35
061-1634	4"	51.82
061-1642	5"	90.25
061-1650	6"	85.21
061-1668	8"	129.38
061-1676	10"	223.28
061-1684	12"	335.37

Threaded
Raised Face 150#

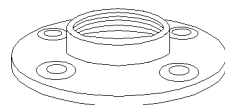

Part #	Size	Price
061-0498	2"	46.23
061-0510	3"	56.97
061-0528	4"	66.25

Blind
Raised Face 150#

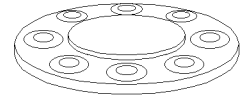

Part #	Size	Price
061-1150	3"	46.78
061-1168	4"	65.56
061-1184	6"	99.82

Forged Steel Flanges - 300#
Weld Neck
Raised Face Standard Bore 300#



Part #	Size	Price
061-0640	3"	69.39
061-0658	4"	114.08
061-0674	6"	177.37

Flat Face Standard Bore 300#

Part #	Size	Price
061-0876	4"	114.08

Raised Face XH Bore 300#

Part #	Size	Price
061-0754	2"	60.00
061-0868	3"	69.39

Blind
Raised Face 300#

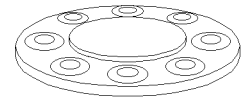

Part #	Size	Price
061-1216	4"	108.52

Forged Steel Flanges - 600#
Weld Neck
Raised Face Standard Bore 600#



Part #	Size	Price
059-9128	2"	67.30
059-9130	3"	97.04
059-9133	4"	209.92
059-9135	6"	342.05
059-9137	8"	658.19
059-9139	10"	921.64

Raised Face XH Bore 600#

Part #	Size	Price
059-9131	3"	97.00

**Blind
Raised Face 600#**

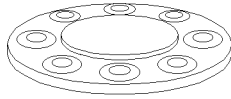

Part #	Size	Price
059-9713	8"	658.19



BONNEY FORGE

BONFORG_THRD_WELD

**Threadolet®
Class 3000 Forged Steel Threadolet®**



Part #	Outlet Size	Run Sizes	Price
070-0007	1/4"	36 - 1/2"	17.80
070-0146	1/2"	36 - 3/4"	13.16
070-0194	3/4"	36 - 1-1/2"	15.17
070-0234	1"	2-1/2 - 1-1/4"	17.67
070-0271	1"	36 - 3"	17.67
070-0318	1-1/4"	3-1/2 - 2"	28.02
070-0354	1-1/4"	36 - 4"	28.02
070-0421	1-1/2"	2-1/2 - 2"	28.02
070-0437	1-1/2"	5 - 3"	28.02
070-0460	1-1/2"	36 - 6"	28.02
070-0511	2"	3-1/2 - 2-1/2"	31.91
070-0533	2"	6 - 4"	31.91
070-0560	2"	36 - 8"	31.91
070-0580	2-1/2"	6 - 4"	31.91
070-0596	2-1/2"	36 - 8"	107.00
070-0640	3 "	14 - 6"	129.76
070-0680	4 "	6 - 5"	241.30
070-0700	4"	10 - 8"	241.30

**Weldolet®
Standard Weight Forged Steel**



Part #	Outlet Size	Run Sizes	Price
069-0650	1"	36 - 2"	30.06
069-0685	1-1/4"	2 - 1-1/2"	10.51
069-0688	1-1/4"	6 - 2-1/2"	10.51
069-0696	1-1/4"	36 - 8"	10.51
069-0716	1-1/2"	3-1/2 - 2"	36.02
069-0728	1-1/2"	36 - 4"	35.71
069-0858	2"	6 - 3-1/2"	36.02

**Weldolet®
Standard Weight Forged Steel (Continued)**

Part #	Outlet Size	Run Sizes	Price
069-0880	2"	36 - 8"	36.02
069-0934	2-1/2"	4 - 3"	82.48
069-1010	2-1/2 "	10 - 5"	82.48
069-1078	3 "	6 - 5"	90.28
069-1130	3 "	14 - 8"	90.28
069-1208	4"	4"	114.08
069-1236	4"	6 - 5"	114.08
069-1280	4"	10 - 8"	114.08

BONFORG_2000

**Forged Steel Fittings - Threaded
90° Elbows - Class 2000 Threaded**



Part #	Mfg #	Size	Price
064-3122	1/4	1/4"	6.88
064-3130	1/2	1/2"	6.97
064-3148	3/4	3/4"	7.60
064-3156	1	1"	9.79
064-3164	1-1/4	1-1/4"	19.57
064-3172	1-1/2	1-1/2"	23.87
064-3358	2	2"	32.74

45° Elbows - Class 2000 Threaded



Part #	Mfg #	Size	Price
064-3366	1	1"	13.27
064-3390	2	2"	41.19

Tees - Class 2000 Threaded



Part #	Mfg #	Size	Price
064-3488	1/4	1/4"	8.79
064-3500	1/2	1/2"	8.44
064-3526	1	1"	15.88
064-3534	1-1/4	1-1/4"	28.10
064-3550	2	2"	42.51



**Forged Steel Fittings - Threaded
Caps - Class 3000 Threaded**



Part #	Size	Price
064-0600	1/4"	3.62
064-0626	1/2"	3.52
064-0634	3/4"	4.90
064-0642	1"	7.52
064-0650	1-1/4"	12.10
064-0668	1-1/2"	14.46
064-0676	2"	20.81
064-0692	3"	105.57

Couplings - Class 3000 Threaded



Part #	Size	Price
064-0004	1/4"	3.56
064-0012	3/8"	3.56
064-0020	1/2"	3.08
064-0038	3/4"	4.01
064-0046	1"	6.98
064-0054	1-1/4"	11.62
064-0062	1-1/2"	15.03
064-0070	2"	18.76
064-0096	3"	87.75

Reducing Couplings - Class 3000 Threaded



Part #	Size	Price
064-0248	1/2" x 1/4"	6.13
064-0264	1/2" x 3/8"	6.13
064-0280	3/4" x 1/2"	7.28
064-0310	1" x 1/2"	9.45
064-0328	1" x 3/4"	9.45
064-0360	1-1/4" x 3/4"	16.59
064-0378	1-1/4" x 1"	16.59
064-0432	1-1/2" x 1"	18.01
064-0440	1-1/2" x 1-1/4"	18.01
064-0538	2" x 1-1/4"	26.12
064-0546	2" x 1-1/2"	26.12

90° Elbows - Class 3000 Threaded



Part #	Size	Price
064-2058	3/8"	9.84

**Forged Steel Fittings - Threaded
90° Elbows - Class 3000 Threaded (Continued)**

Part #	Size	Price
064-2040	1/4"	9.84
064-2058	3/8"	9.84
064-2066	1/2"	7.54
064-2074	3/4"	9.46
064-2082	1"	14.06
064-2090	1-1/4"	26.71
064-2104	1-1/2"	34.46
064-2112	2"	41.85
064-2120	2-1/2"	123.87

90° Street Elbows - Class 3000 Threaded



Part #	Size	Price
064-4238	3/8"	14.19
064-4246	1/2"	14.19

45° Elbows - Class 3000 Threaded



Part #	Size	Price
064-1804	1/4"	12.49
064-1820	1/2"	12.31
064-1838	3/4"	14.22
064-1846	1"	19.37
064-1854	1-1/4"	26.77
064-1862	1-1/2"	38.43
064-1870	2"	53.03

Tees - Class 3000 Threaded



Part #	Size	Price
064-2162	1/4"	11.95
064-2170	3/8"	11.95
064-2188	1/2"	10.76
064-2196	3/4"	14.53
064-2200	1"	19.14
064-2218	1-1/4"	37.14
064-2226	1-1/2"	43.32
064-2234	2"	56.03

INDEPENDENT WHOLESALE DISTRIBUTOR



BONNEY FORGE

Effective Date 03/02/2010



**NORTHWEST PIPE
FITTINGS, Inc.**
Rapid City, South Dakota

Square Head Plugs - Class 3000 Threaded



Part #	Size	Price
064-2776	1/4"	1.63
064-2784	3/8"	1.71
064-2792	1/2"	1.80
064-2806	3/4"	2.24
064-2814	1"	3.42
064-2822	1-1/4"	7.05
064-2830	1-1/2"	8.05
064-2848	2"	12.72
064-2864	3"	54.74

Hex Head Plugs - Class 3000 Threaded

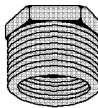

Part #	Size	Price
064-2646	1/4"	1.37
064-2662	1/2"	1.43
064-2670	3/4"	2.64
064-2688	1"	3.72
064-2718	2"	13.95

Hex Bushings - Class 3000 Threaded

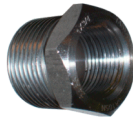

Part #	Size	Price
064-0844	1/4" x 1/8"	2.26
064-0886	3/8" x 1/4"	2.26
064-0924	1/2" x 1/8"	2.27
064-0932	1/2" x 1/4"	2.27
064-0940	1/2" x 3/8"	2.27
064-1006	3/4" x 1/4"	2.79
064-1014	3/4" x 3/8"	2.79
064-1022	3/4" x 1/2"	2.79
064-1080	1" x 1/8"	4.54
064-1098	1" x 1/4"	4.54
064-1110	1" x 1/2"	4.54
064-1128	1" x 3/4"	4.54
064-1208	1-1/4" x 1/2"	7.40
064-1216	1-1/4" x 3/4"	7.40
064-1224	1-1/4" x 1"	7.40
064-1320	1-1/2" x 1/2"	8.52
064-1338	1-1/2" x 3/4"	8.52
064-1346	1-1/2" x 1"	8.52
064-1354	1-1/2" x 1-1/4"	8.52
064-1450	2" x 3/4"	12.79
064-1468	2" x 1"	12.79
064-1476	2" x 1-1/4"	12.79
064-1484	2" x 1-1/2"	12.79

**Forged Steel Fittings - Threaded
Hex Bushings - Class 3000 Threaded (Continued)**

Part #	Size	Price
064-1564	2-1/2" x 2"	40.10
064-1658	3" x 1"	62.03
064-1686	3" x 2"	62.03

Unions - Class 3000 Threaded

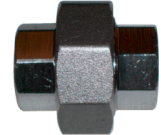

Part #	Size	Price
064-2410	3/8"	15.39
064-2428	1/2"	12.96
064-2436	3/4"	16.00
064-2444	1"	20.90
064-2452	1-1/4"	33.16
064-2460	1-1/2"	39.54
064-2478	2"	53.61
064-2494	3"	156.40

Unions - Class 3000 Threaded - Lug, SxS Seat

Part #	Size	Price
064-3840	1/2"	31.48
064-3866	1"	26.85
064-3882	1-1/2"	77.32
064-3890	2"	53.12

INDEPENDENT WHOLESALE DISTRIBUTOR



BONFORG_3000-SOLVW

**Forged Steel Fittings - Socket Weld
Couplings - Class 3000 Socket Weld**

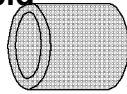

Part #	Mfg #	Size	Price
065-1664	3/4	3/4"	6.62
065-1672	1	1"	7.30
065-1680	1-1/4	1-1/4"	12.93
065-1698	1-1/2	1-1/2"	14.30
065-1702	2	2"	22.84

Reducing Couplings - Class 3000 Socket Weld

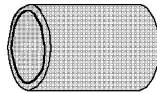

Part #	Mfg #	Size	Price
065-1882	3/4X1/2	3/4" x 1/2"	18.16
065-1911	1X1/2	1" x 1/2"	21.04
065-1912	1X3/4	1" x 3/4"	21.04
065-1952	1-1/4X1/2	1-1/4" x 1/2"	32.39
065-1954	1-1/4X3/4	1-1/4" x 3/4"	32.39
065-1962	1-1/4X1	1-1/4" x 1"	32.39
065-1986	1-1/2X1/2	1-1/2" x 1/2"	34.72
065-1988	1-1/2X3/4	1-1/2" x 3/4"	34.72
065-1996	1-1/2X1	1-1/2" x 1"	34.72
065-2002	1-1/2X1-1/4	1-1/2" x 1-1/4"	34.72
065-2048	2X1/2	2" x 1/2"	38.38
065-2050	2X3/4	2" x 3/4"	38.38
065-2051	2X1	2" x 1"	38.38
065-2052	2X1-1/4	2" x 1-1/4"	38.38
065-2060	2X1-1/2	2" x 1-1/2"	38.38

Reducer Inserts - Class 3000 Socket Weld

Part #	Mfg #	Size	Price
065-2922	3/4X1/2	3/4" x 1/2"	12.03
065-2972	1X1/2	1" x 1/2"	13.17
065-2980	1X3/4	1" x 3/4"	13.17
065-3040	1-1/4X1/2	1-1/4" x 1/2"	15.45
065-3046	1-1/4X3/4	1-1/4" x 3/4"	15.45
065-3096	1-1/2X1/2	1-1/2" x 1/2"	19.31
065-3100	1-1/2X3/4	1-1/2" x 3/4"	19.31
065-3118	1-1/2X1	1-1/2" x 1"	19.31
065-3190	2X1/2	2" x 1/2"	26.43
065-3206	2X1	2" x 1"	26.43

90° Elbows -Class 3000 Socket Weld

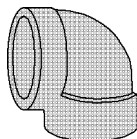

Part #	Mfg #	Size	Price
065-0040	1/2	1/2"	9.94

**Forged Steel Fittings - Socket Weld
90° Elbows -Class 3000 Socket Weld (Continued)**

Part #	Mfg #	Size	Price
065-0058	3/4	3/4"	10.35
065-0066	1	1"	13.28
065-0074	1-1/4	1-1/4"	25.53
065-0082	1-1/2	1-1/2"	29.65
065-0090	2	2"	43.62

45° Elbows - Class 3000 Socket Weld

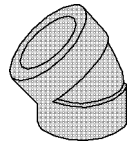

Part #	Mfg #	Size	Price
065-0402	1/2	1/2"	13.24
065-0410	3/4	3/4"	15.39
065-0428	1	1"	20.13
065-0436	1-1/4	1-1/4"	27.60
065-0444	1-1/2	1-1/2"	33.82
065-0452	2	2"	54.39

Tees - Class 3000 Socket Weld

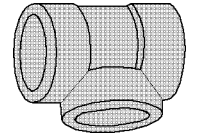

Part #	Mfg #	Size	Price
065-0768	1/2	1/2"	12.31
065-0776	3/4	3/4"	15.15
065-0784	1	1"	20.45
065-0792	1-1/4	1-1/4"	31.42
065-0806	1-1/2	1-1/2"	41.63
065-0814	2	2"	60.10

Unions - Class 3000 Socket Weld

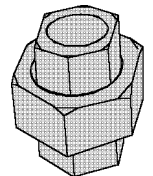

Part #	Mfg #	Size	Price
065-1244	1/2	1/2"	19.89
065-1252	3/4	3/4"	23.21
065-1260	1	1"	29.90
065-1278	1-1/4	1-1/4"	48.22
065-1286	1-1/2	1-1/2"	52.23
065-1294	2	2"	75.19



INDEPENDENT WHOLESALE DISTRIBUTOR